

Unboxing

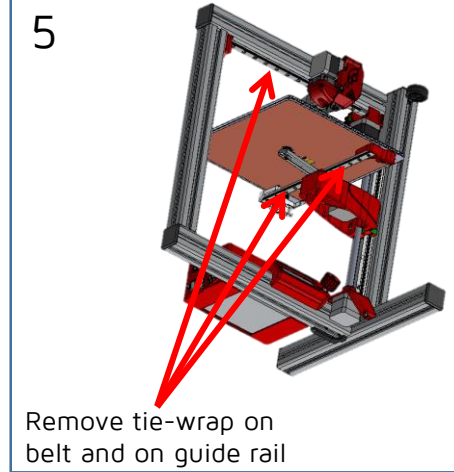

Install Accessories

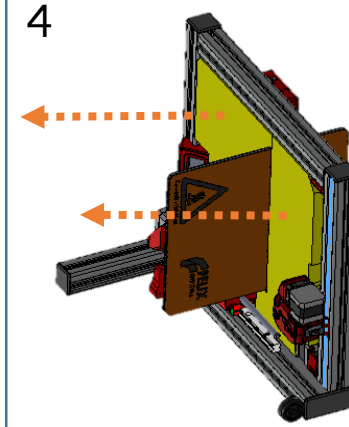
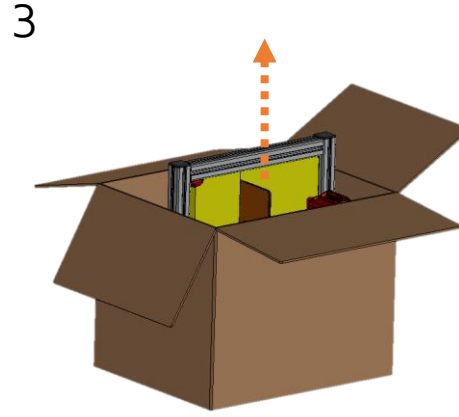
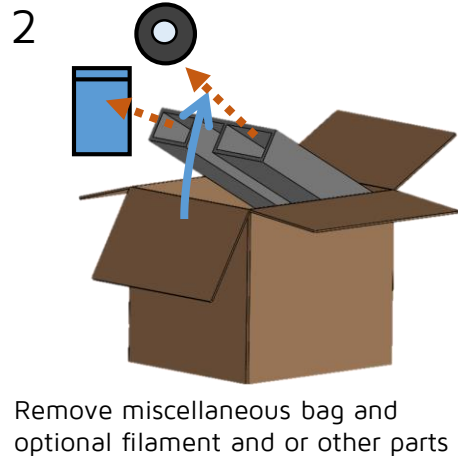
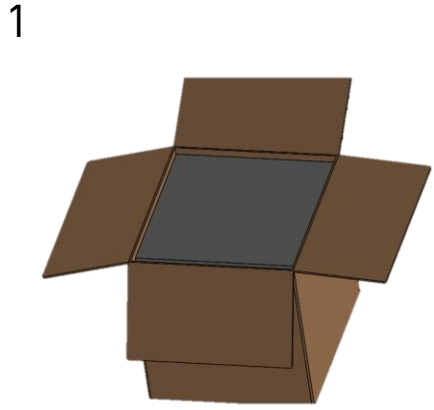
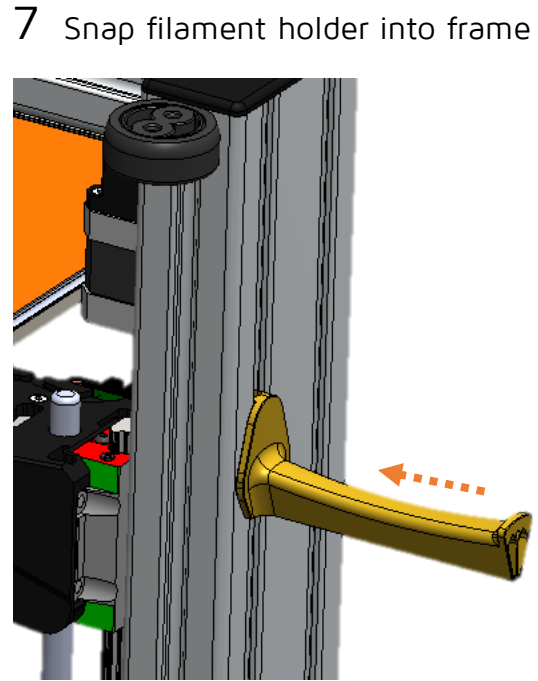
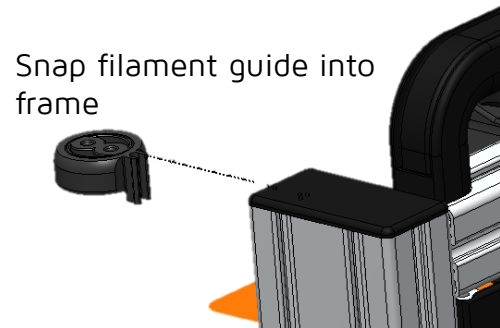
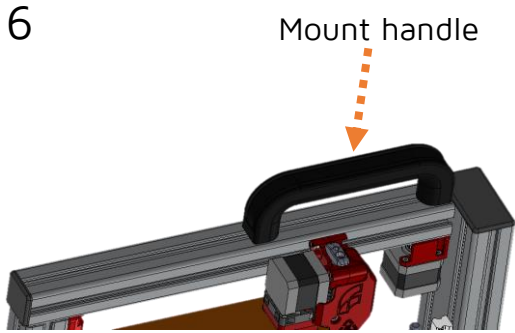

10

Place filament roll(s) and guide the filament to the extruder entry

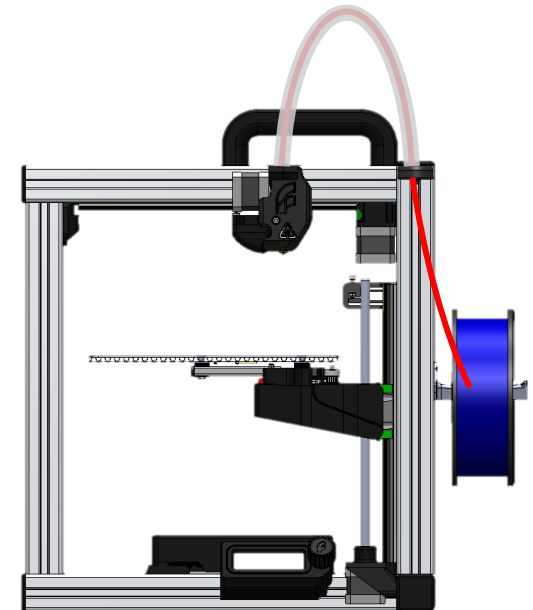

11

Move table up, by turning the spindle by hand

Front View

12 Three adjustment points, calibrate distance between nozzle and table along displayed lines.

Turn nut to adjust height

Side View

13

Side View

14

Turn Nut to adjust height. **Slowly** move extruder along x-axis to verify that table is level

15

Download & Install setupRepetierHostFELIXPrinters_*.exe
www.FELIXprinters.com/downloads

17 Start Repetier - Host

19

20

Connect to printer

16

Connect USB & Power Plug

18

Open Printer Settings

1. Select your printer.
 2. Press "Refresh Ports" button, and then select the correct COM-port
 3. Press OK

21

Idle indicates successful connection

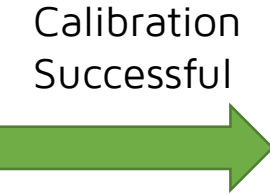
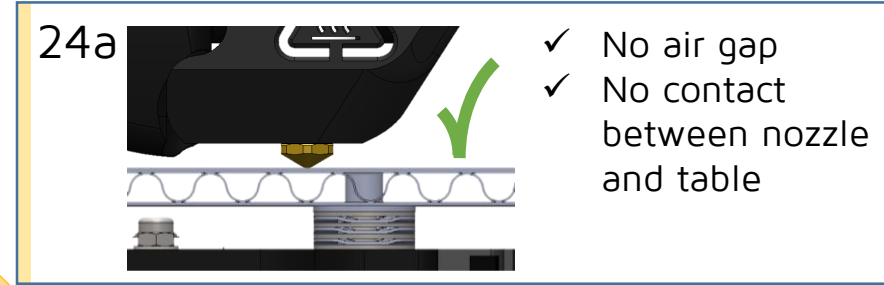
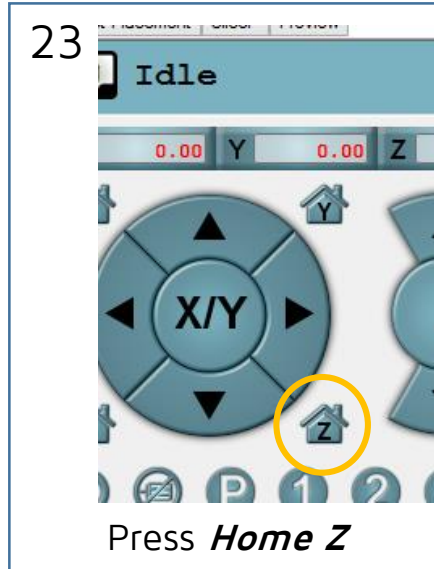
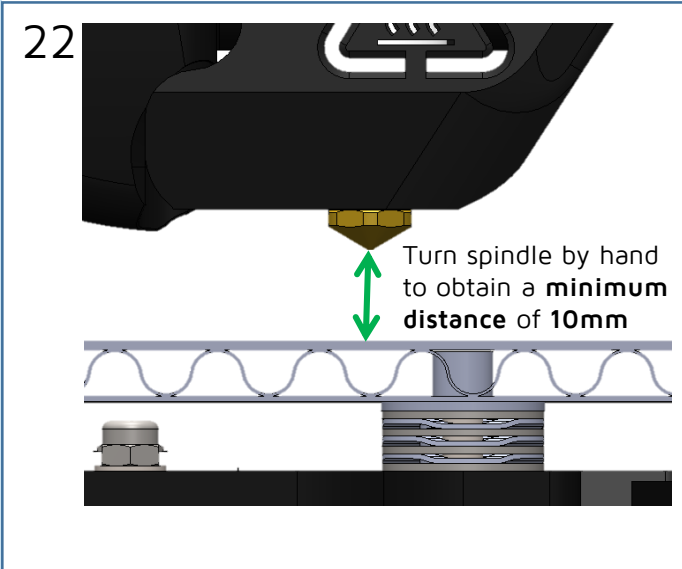

NOTE:
This calibration step together with previous calibration of table are very important for the following reasons:

- ✓ Prevents damage to printer
- ✓ Ensures optimal adhesion of object to print bed.

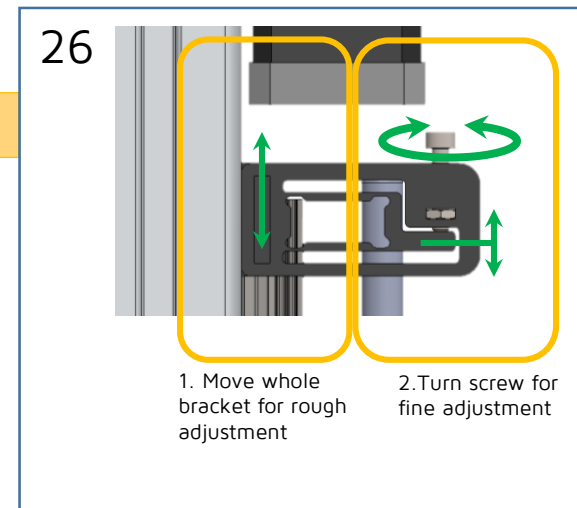

NOTE:
Lowering the switching vane means that the print bed will stop further away from the nozzle tip.

27

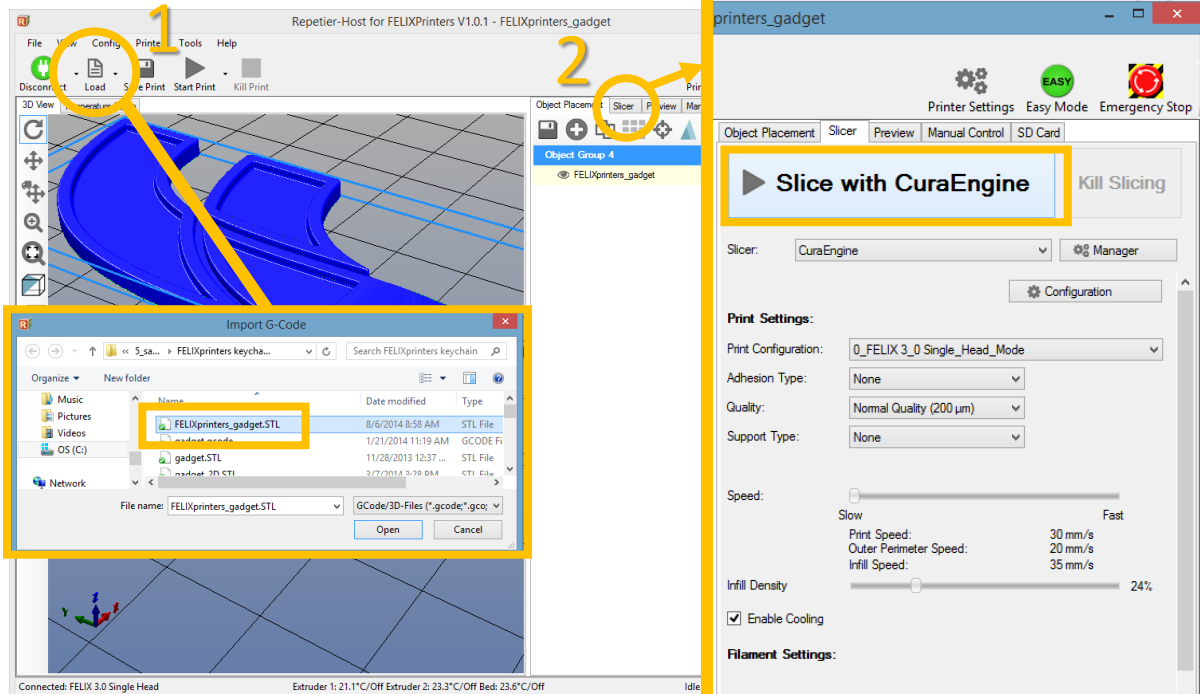

Check if settings match

Download testfile *FELIXprinters_gadget.STL* from www.FELIXprinters.com/downloads

28

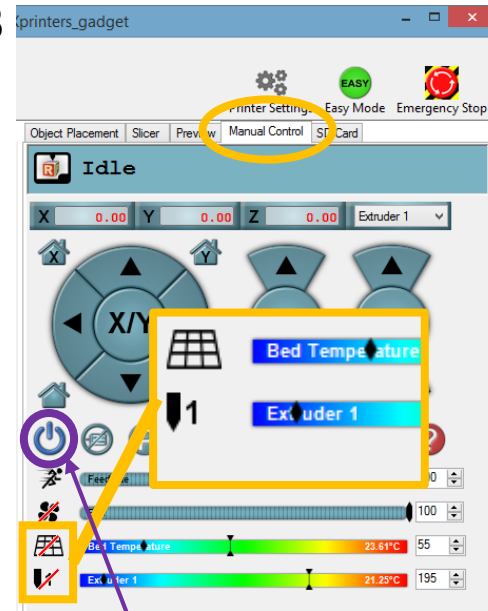

- ✓ Clean the heated bed with a detergent like blue spirit or alcohol
- ✓ Press indicated temperature buttons
- ✓ Check if temperature is rising.
 - If not press this button twice; the printer might be in standby mode due to long inactivity.

29

- ✓ Wait until temperature set points are reached.
- ✓ Make sure nothing is blocking any axes

30

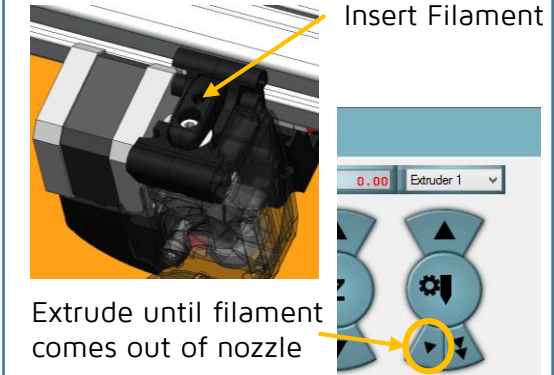

Extrude until filament comes out of nozzle

Note: Only works when temperature > 150°C

31

Start Print

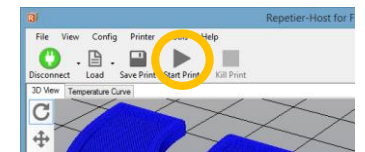

32a

If print object didn't adhere correctly to the heated bed, please go to step 23 and 28

Remove object after print completes:

- ✓ Let bed cool down
- ✓ Don't vertically pull object away from print bed.
- ✓ Start peeling at edges
- ✓ After peeling edge, try to twist it from bed.

32b

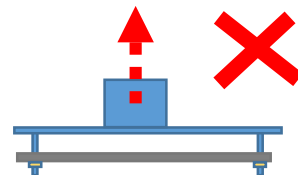

32c

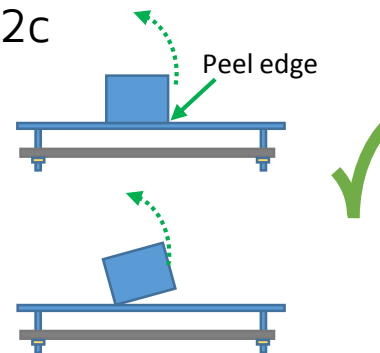

33

Congratulations, you've made your first print!

Tip: consult the **user manual** for more detailed information, and join our **user forum** to get the most out of your printer