



Printer upgrade
Heated tube upgrade

Intro

This guide will explain how to install the heated tube upgrade to your Felix food printer.

Whats in the box

- 1x** Heated tube (single)
or
- 2x** Heated tube (switch)
- 2x** Cable clamp (L and R)
- 4x** M4x8 countersunk bolt.

Tools Needed



● 2.50mm

REMINDER: You can use excessive force in some bolts.
Always tighten bolts with extra care !!

Time: approx 10 minutes



1. Remove the syringe if there is one loaded in the machine.



2. Remove the old tube/syringe holder.



3. Take the tube holder out of the packaging foam.

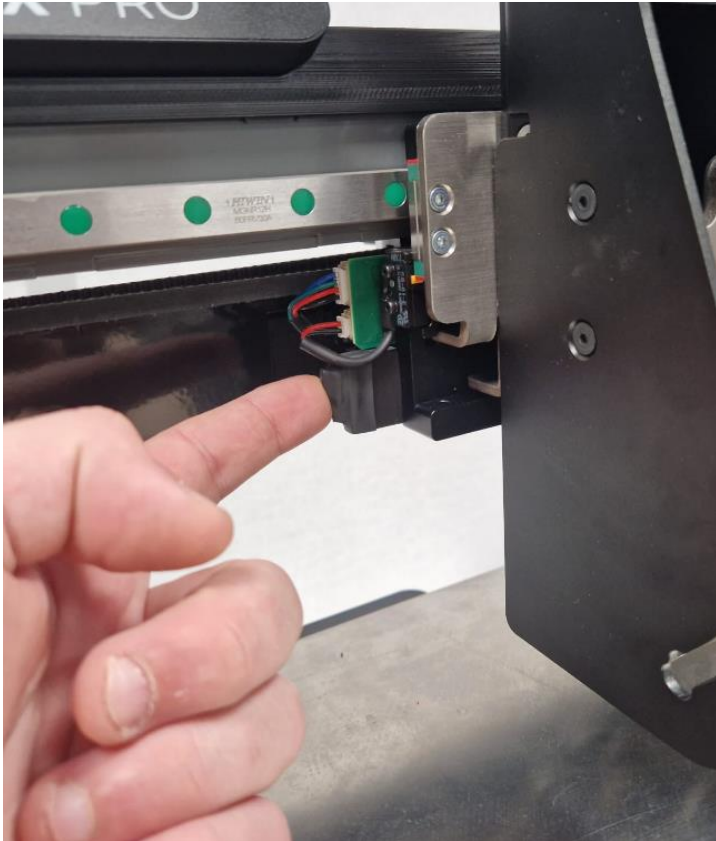

4. Locate the temperature sensor dongle/placeholder.

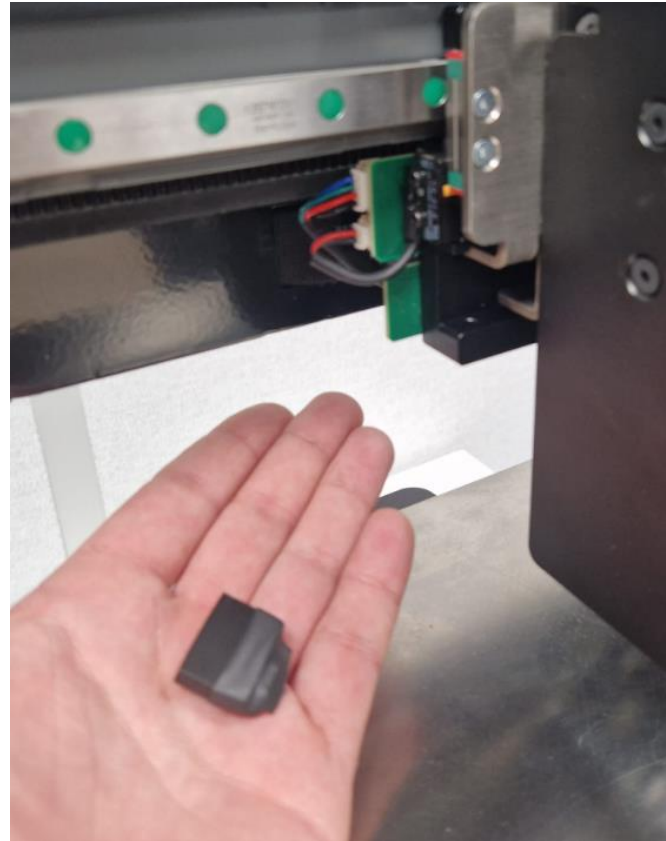

5. Slide the dongle to the left side to remove it.



6. Locate the **2x M4 bolts** at the left side of the extruder. Remove the bottom bolt.



7. Repeat the step for the top bolt.



8. Take the cable clamp and bolts out of the box.

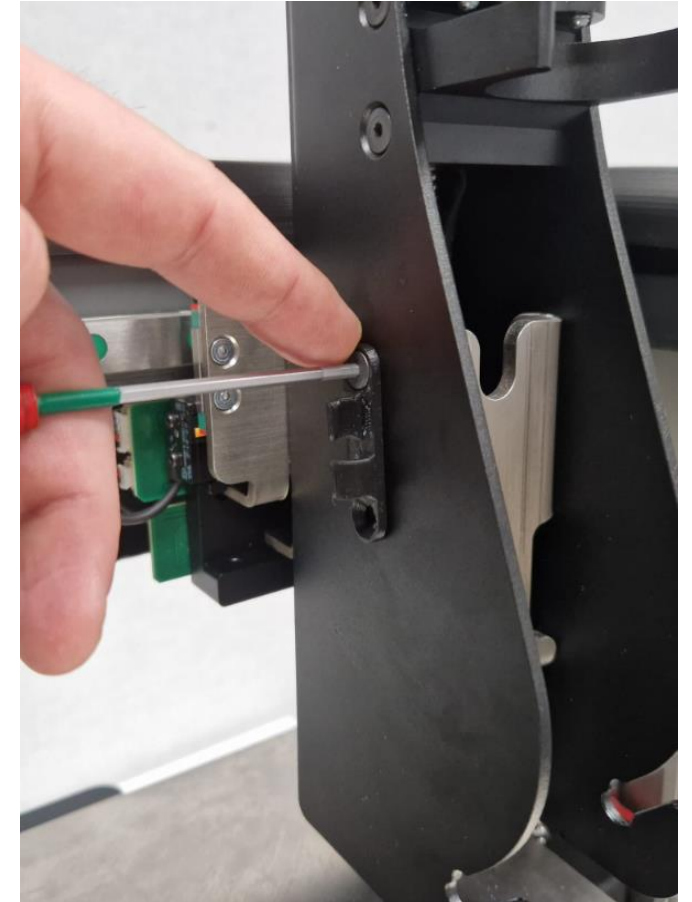

9. Mount the cable clamp to the left side of the extruder. Fasten the top bolt.

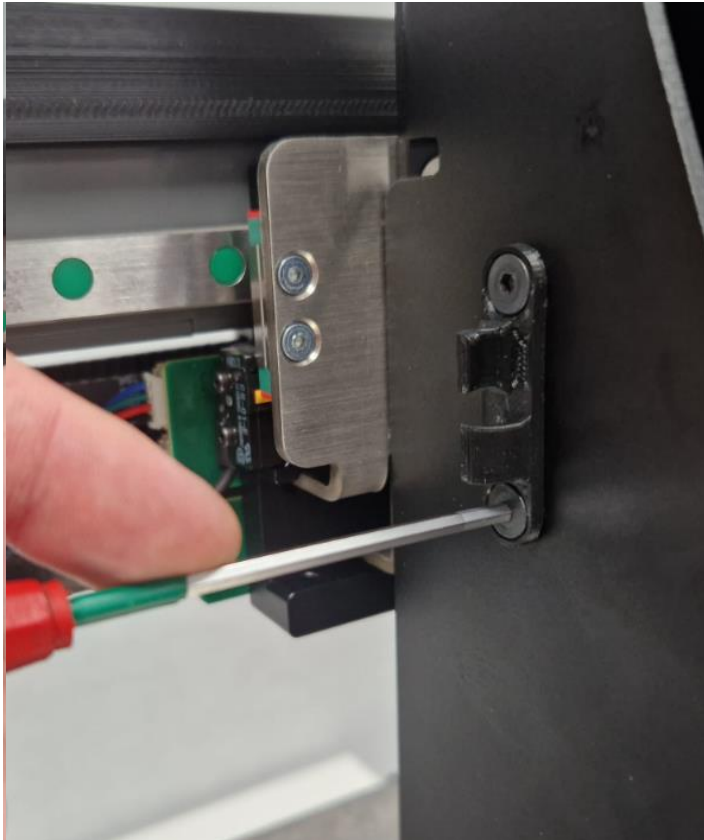

10. Repeat the step for the bottom bolt.



11. Place the heated tube in the extruder.



12. Slide the connector over the PCB. (see cable configuration)

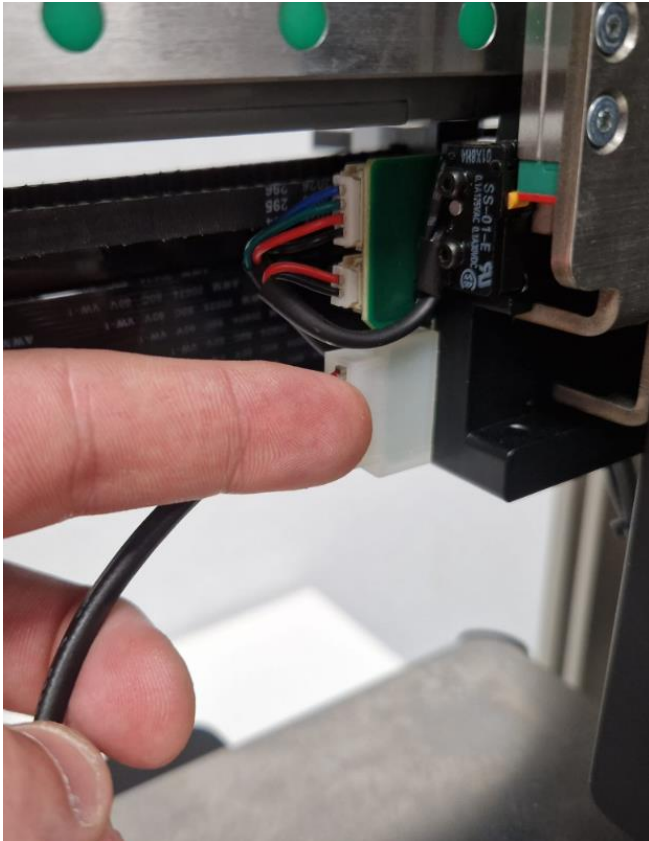

13. Fully push the edge connector to ensure a good connection.



14. Place the cable in the cable clamp at the left side of the extruder.

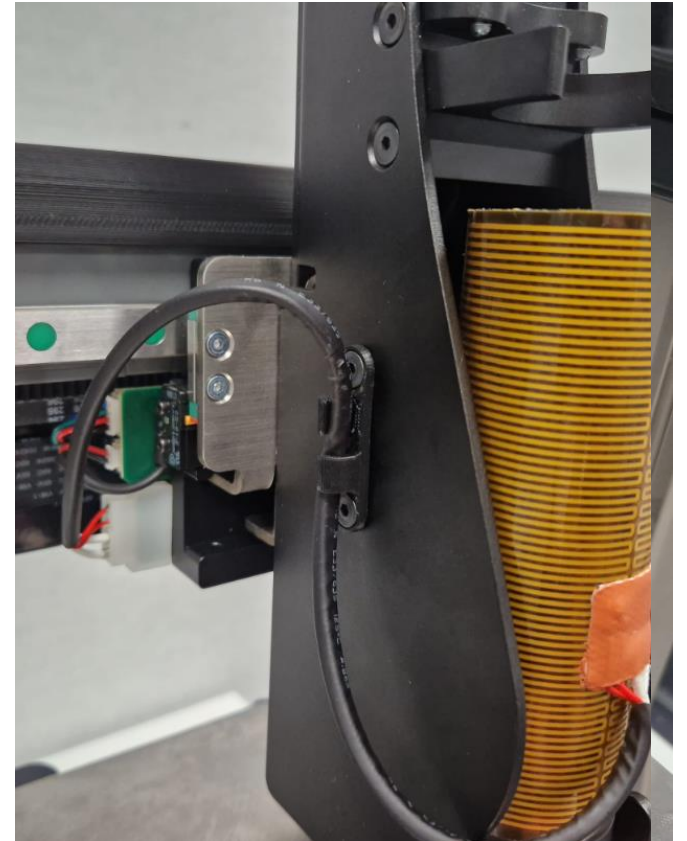

15. Installation complete!
Repeat the steps for the right extruder.

Cable configuration

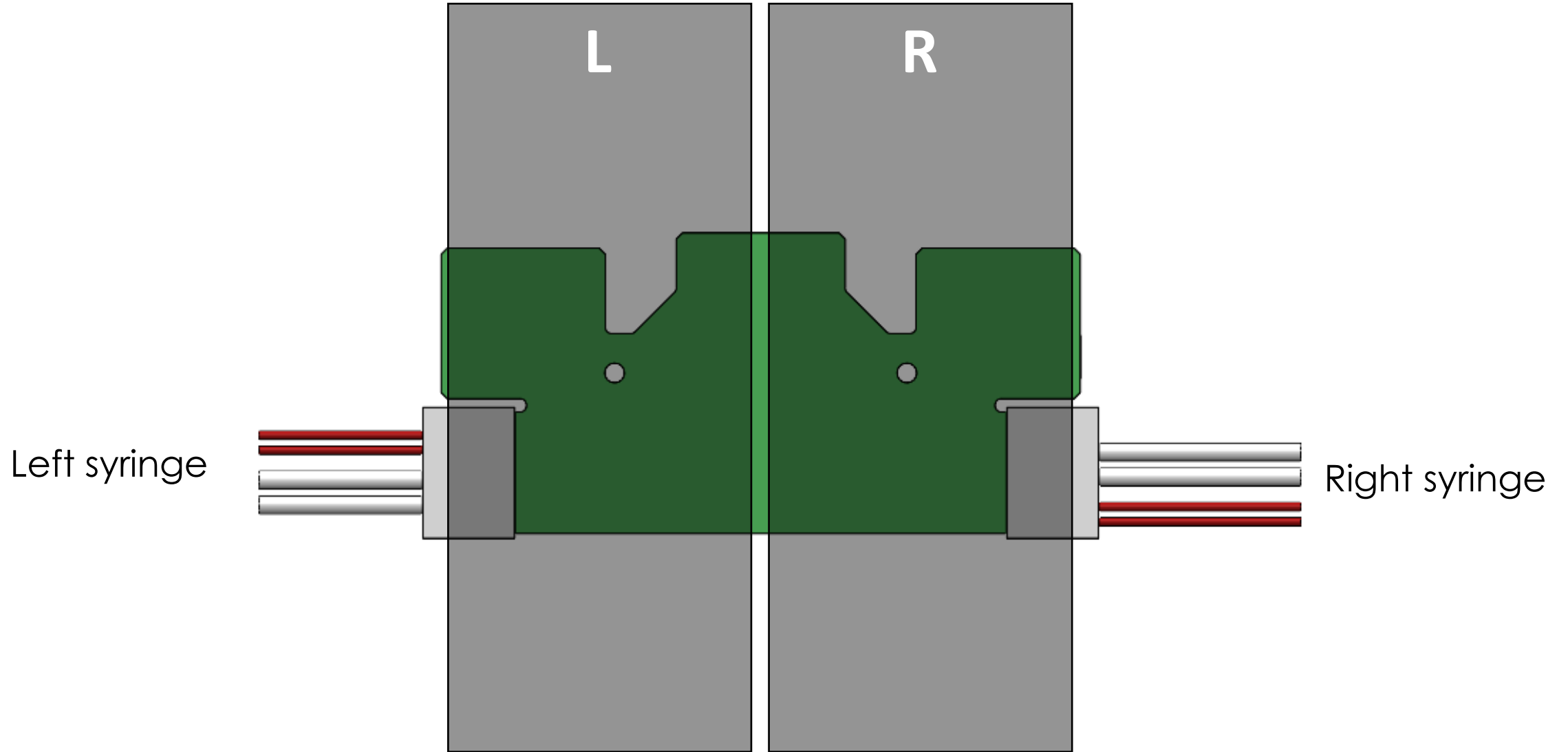

Completed!



[CHANNEL/FELIXPrinters](#)



[Company/FELIXPrinters](#)



[Facebook.com/felixprinters](#)